

SUMO EHT 100 TRACTOR Line Drawings

HAULAGE TRACTOR

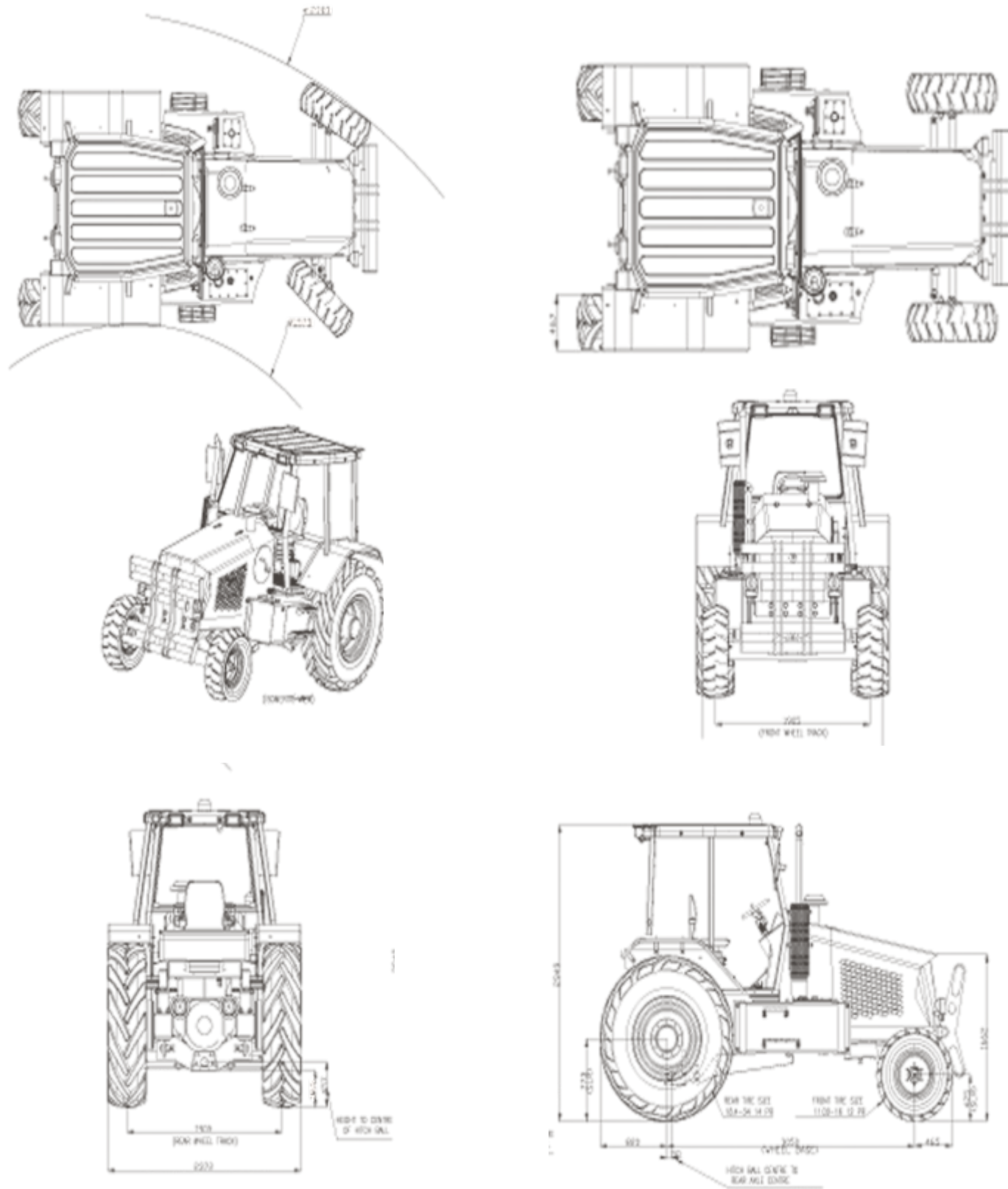

The information contained in this leaflet is intended to be of general nature only. We reserve the right to change the specifications without any prior notice. All dimensions and weights are variable with in $\pm 2.5\%$

SUMO EHT 100

Reliable Hauling Solutions
Lowest Total Cost
Unmatched Stability



Escorts Construction Equipment Limited Plot No. 219, Sector 58, Ballabgarh-121 004, Haryana, India
Tel.: +91 129 2306566, Fax: +91 129 2306463 | e-mail: marketing@escorts-ecel.com | www.ecel.com

Customer Support (Toll free) : 1800-180-1890

LIT / MKTG / SUMO EHT 100/ 06-12

POWERFUL • STABLE • RELIABLE

Specifications

ENGINE

Model	▶ Cummins 3.9 102C
Configuration	▶ Four-cylinder, in-line
Aspiration	▶ Turbo charged
Displacement	▶ 3900 cc
Injection type	▶ Direct, In-line HP mechanical pump
Power Rating (at rated speed without fan)	▶ 75 kW@2200 rpm
Maximum torque (Net, Nm @ RPM)	▶ 101 BHP@2200 rpm
	▶ 385 @ 1300
Low Idle	▶ 850 rpm
High Idle	▶ 2550 rpm
Cylinder bore	▶ 102 mm
Stroke	▶ 120 mm
Compression Ratio	▶ 17.6:1

TRANSMISSION

Model	▶ Allison #2500, TC 211
Layout	▶ Engine mounted with flex plate and coaxial rear output through planetary g/box
Gear layout	▶ Constant meshing planetary gears.
Clutch type	▶ Hydraulic operated, multiple disc
Control type	▶ Electronic control over hydraulic actuation.
Dry Weight	▶ 149
Torque converter layout	▶ Hydrodynamic with lock-up (L) in 2-6 gears and converter (C) mode in gears 1 & 2

Max Theoretical Wheel Torque in Converter Mode

1	▶ 54.2 kNm
2	▶ 29.3 kNm
3	▶ 22.2 kNm
4	▶ 15.4 kNm
5	▶ 11.4 kNm
6	▶ 10.0 kNm
Reverse	▶ 78.6 kNm

TRANSFER CASE

Model	▶ NA
Layout	▶ NA

REAR AXLE (2WD)

Type	▶ MERITOR 13T, Steel Fabricated
Differential type	▶ Hypoid, 6.83:1
Hub reduction type	▶ 3.46:1

SUSPENSION

Front	▶ Above-centre pivoted
Rear	▶ Rigid Mounted Axle



Renounced & reliable drive line Cummins engine+ Allison Transmission+Meritor Fabricated design axle.

BRAKING SYSTEM

Service Brake Type	▶ Type 24/75 pneumatic booster, heavy duty drum type, air activated S-cams and automatic slack adjuster on rear drive wheels.
Emergency Brake Type	▶ Hand control valve type fail safe brake on rear drive wheel only.

FRONT AXLE

Type	▶ ECEL steel fabricated ,Steered Axle (2WD)
------	---

FRONT WHEELS

Tyre size and Type	▶ 11.00 X16 12 PR Multi Rib
Inflation Pressure	▶ 410 kPa
Maximum speed Rating	▶ 40 kmph
Rim Size	▶ 16.00X10.00 LB

REAR WHEELS

Tyre size and Type	▶ 18.4-34 14 PR TR135 HD SPL
Inflation Pressure	▶ 230 kPa
Maximum speed Rating	▶ 40 kmph
Rim Size	▶ 34.00XDW 16L

MACHINE SPEED (UNLADEN)

1st gear	▶ 7.2 kmph
2nd gear	▶ 15 kmph
3rd gear	▶ 19.7 kmph
4th gear	▶ 28.3 kmph
5th gear	▶ 38.5 kmph
6th gear	▶ 40.0 kmph (Limited)
Reverse	▶ 5.0 kmph

COOLING SYSTEM

Engine cooler type	▶ Aluminium radiator water based, with series transmission oil cooler.
--------------------	--

PNEUMATIC SYSTEM

Compressor Type	▶ Piston Type
System pressure	▶ 800 kPa
Compressor rating	▶ 352 litres/min
Air reservoir capacity	▶ 30 Litres
Auxiliary (Trailer)air supply	▶ Palm Coupler (Service and emergency)at vehicle rear



Heavy duty, torsion free, four plate box construction chassis for longer life reliability.

HYDRAULIC SYSTEM

Type	▶ Open centre, Load sensing with Priority valve
Pump type & displacement	▶ Engine gear driven (1: 1 ratio), gear pump, 19.8 cc per revolution
Primary pump displacement (cc/ Rev)	▶ 19.8
Pump Application	▶ Power steering,hitch lift and trailer auxillary (2 function direct lever controlvalve)
Pump Flow @ engine	▶ 43.5 l/min@2200

ELECTRICAL SYSTEM

Voltage	▶ 12 V
Battery type	▶ Maintenance free, sealed type
Startermotor rating	▶ 2.8 kW
Alternator rating	▶ 12/55 V/A
Battery rating	▶ 150 AH
Battery Isolator Switch	▶ Double pole type, accessible in cabin
Auxiliary (Trailer) electrical supply	▶ Standard trailer plug at vehicle rear
Fuse box	▶ Inside Cabin with function decal

STEERING SYSTEM

Type	▶ Hydraulic power assisted with integrated priority valve
------	---

CANOPY

Type	▶ Open rotomould roof with Front wind shield
Ventillation	▶ Fresh air ventilated .
Seat	▶ Ergonomically Designed, Mechanical suspension cushioned seat with reclining & height adjustment. Lap strap restraining belt.
Dashboard	▶ Rotomould LDPE.

FLUID CAPACITIES

Fuel	▶ 200 litres
Hydraulic Oil (tank & system)	▶ 75 litres
Coolant	▶ 25.5 litres
Rear axle	▶ 44.0 litres
Engine crankcase Oil	▶ 09.0 litres
Transmission oil (and cooler)	▶ 14.0 litres

GRADEABILTY

Max. Theoretical Drive line Gradability-20% (But limited by tyre slip to 18 %)



Heavy duty, Rugged, easy to operate Hitch Assembly.

INSTRUMENTATION

Type	▶ Electronic with fully display and warning system including fault logging on critical functions.
Needle Gauges	▶ Coolant Temperature Vehicle speed (with overspeed warning light) Engine RPM Air brake Pressure Fuel Gauge Digital hourmeter Transmission Oil temperature with warning light) Engine Oil Pressure Gauge (with low warning light)
Indicators	▶ Integrated Tell Tale indicators for turning; parking Brake; Transmission Inhibitor; Battery Charging; High engine oil Pressure; High Beam etc.

OPERATING MASS

Unladen	
Front	▶ 2,350 Kgs
Rear	▶ 3,250 Kgs
Total	▶ 5,600 Kgs

Legally Laden(8000kg/Rear axle)

Front	▶ 2,430 Kgs
Rear	▶ 8,000 Kgs
Total	▶ 10,430 Kgs
Hitch Load (Legally Laden)	▶ 4,830 Kgs

Fully Laden (5870kg hitch load)

Front	▶ 2,450 Kgs
Rear	▶ 9,020 Kgs
Total	▶ 11,470 Kgs
Hitch Load (Fully Laden)	▶ 5,870 Kgs
GCW	▶ 28,000 Kgs
Payload	▶ 22,400 Kgs

STANDARD EQUIPMENT

Hydraulic Hitch with diameter 90 ball, Fleetguard air pre-cleaner, Front wind shield Guard

OPTIONAL EQUIPMENT

Belly Plates

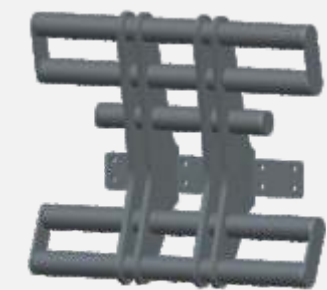

Aesthetically designed, Heavy duty, Impact resistant front dozer assembly.